

BVM TYPE C CASING SLIPS

BVM Type C Casing Slips are designed to handle tubing or casing from 7" through 20" OD. These slips are light-weight, self-centering and have a full circle grip to prevent damage to thin tubular walls. Slips are made from alloy steel, heat treated and tested for maximum durability. All steel specifications are certified.

BVM CORPORATION
 430 S. NAVAJO STREET, DENVER CO 80223
 PHONE: 303-975-1402; FAX: 303-975-0981
 www.bvmcorp.com; sales@bvmcorp.com

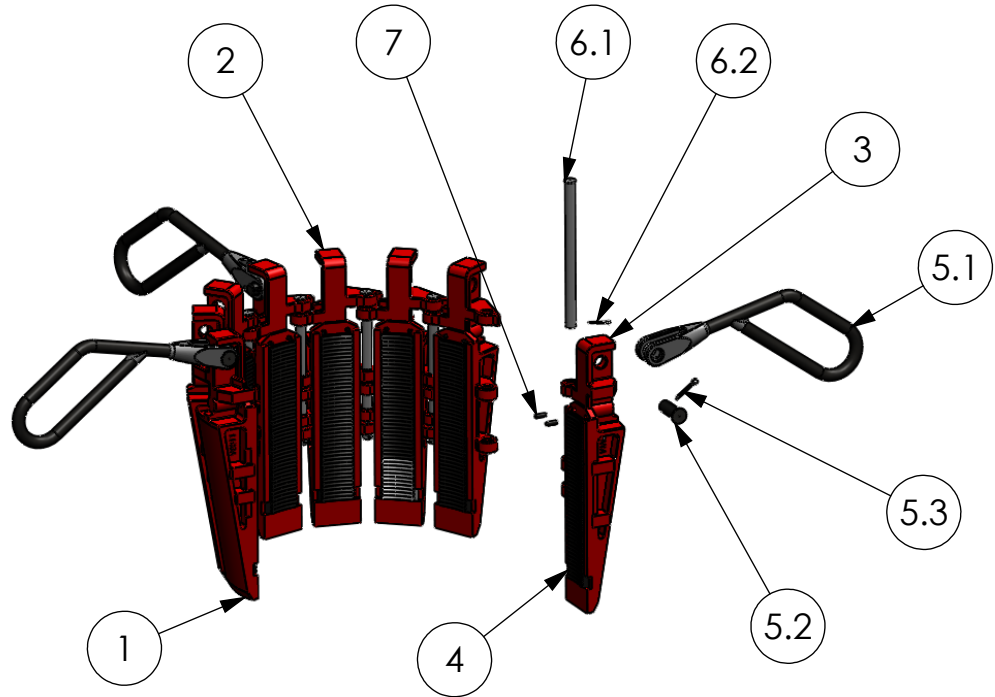

8 5/8" CASING SLIP SHOWN

GRIP LENGTH (INSERTS) 11"

Casing Size	Complete Slip Assembly		Body Segment			Insert	Handle	Handle Pin	Cotter Pin	Hinge Pin	Cotter Pin	Roll Pin
			Left	Center	Right	Part No. / No. Req'd						
	Item No.		1	2	3	4	5.1	5.2	5.3	6.1	6.2	7
	Part No.		98310	98311	98312	-	98714	98717-1	30030-10-0	98315-1	30020-08-0	40040-06-0
		Weight (lbs)	17.7	18.3	17.7	0.6	4.2	0.27	0.01	0.7	0.01	0.01
7"	98302	160	1	6	1	717-700-0570 / 32	3	3	3	7	7	16
7 5/8"	98303	160	1	6	1	717-700-0575 / 32	3	3	3	7	7	16
8 5/8"	98304	160	1	6	1	717-700-0585 / 32	3	3	3	7	7	16
9 5/8"	98305	182	1	7	1	717-700-0595 / 36	4	4	4	8	8	18
10 3/4"	98306	182	1	7	1	717-700-5106 / 36	4	4	4	8	8	18
11 3/4"	98307	218	1	9	1	717-700-5116 / 44	4	4	4	10	10	22
13 3/8"	98308	218	1	9	1	717-700-5133 / 44	4	4	4	10	10	22
16"	98309	259	1	11	1	717-700-5160 / 52	4	4	4	12	12	26
18 5/8"	98319	278	1	12	1	717-700-5185 / 56	4	4	4	13	13	28
20"	98320	317	1	14	1	717-700-5200 / 64	4	4	4	15	15	32