

# BVM C SAFETY CLAMP

The BVM "C" Safety Clamp is designed to handle drill collars and tubulars with flush joints or low profile shoulders. If the load is increased or the pipe is dropped the BVM web shaped dies will grip tighter. BVM "C" Safety Clamp comes in sizes to fit pipe sizes from 3 3/4" to 43". The "C" Safety Clamp is made from alloy steel, heat treated and magnetic particle inspected. All steel specifications are certified.

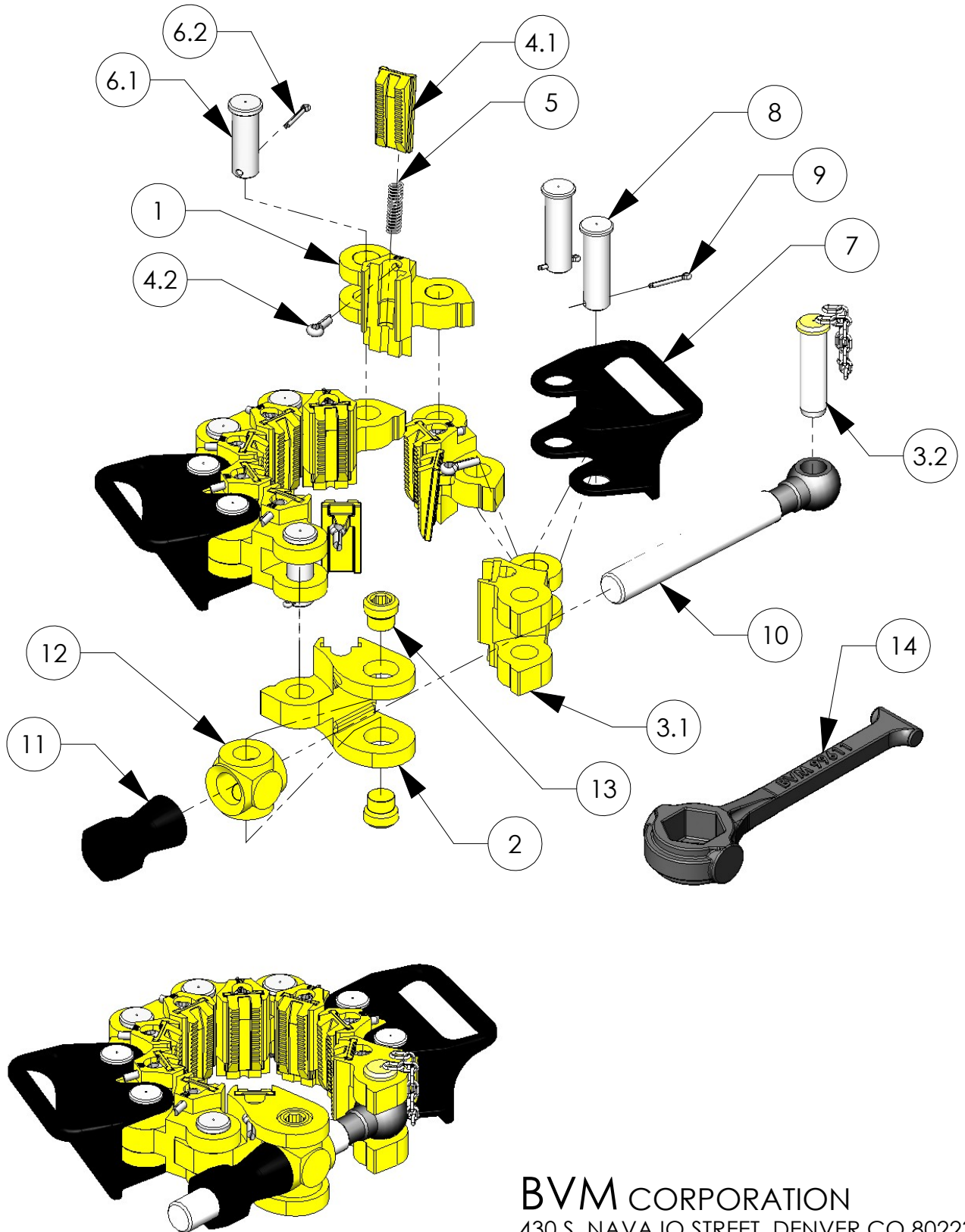

7/1/21

CS99502 SHOWN

**BVM CORPORATION**

430 S. NAVAJO STREET, DENVER CO 80223  
PHONE: 303-975-1402; FAX: 303-975-0981  
www.bvmcorp.com; sales@bvmcorp.com

# BVM C SAFETY CLAMP

## Replacement parts

| ITEM NO. | PART NO    | O.E.M. P/N  | CS & CM QTY | CL QTY   | DESCRIPTION                                 | WEIGHT |
|----------|------------|-------------|-------------|----------|---|--------|
| --       | 99613      | 7624-A-7    | --          | --       | COMPLETE LINK ASSEMBLY (ITEMS 1, 4, 5, & 6) | --     |
| 1        | 99601      | 7624-A-1    | AR          | AR       | CENTER LINK                                 | 3.4    |
| 2        | 99600      | 7624-A-24   | 1           | 2        | END LINK PIVOT BLOCK                        | 4.1    |
| 3        | 99620      | --          | 1           | 2        | END LINK & PIN ASSEMBLY                     | 5.4    |
| 3.1      | 99602      | 7624-A-3    | --          | --       | END LINK                                    | 4.4    |
| 3.2      | 99610-1    | --          | --          | --       | END LINK PIN                                | 0.9    |
| 3.3      | 99610-2    | --          | --          | --       | CHAIN                                       | --     |
| 4        | 99608-1    | 7624-A-1    | AR          | AR       | INSERT w/COTTER PIN                         | --     |
| 4.1      | 99608      | --          | 1/Item 4    | 1/Item 4 | INSERT                                      | 0.5    |
| 4.2      | 30030-06-0 | 900620-65   | 1/Item 4    | 1/Item 4 | COTTER PIN                                  | 0.1    |
| 5        | 99609      | 7624-E-5    | AR          | AR       | INSERT SPRING                               | --     |
| 6        | 99607      | --          | AR          | AR       | INTERMEDIATE LINK PIN w/COTTER PIN          | --     |
| 6.1      | 99607-1    | 7624-C-5    | 1/Item 6    | 1/Item 6 | INTERMEDIATE LINK PIN                       | 0.7    |
| 6.2      | 30030-10-0 | 900620-38   | 1/Item 6    | 1/Item 6 | COTTER PIN                                  | 0.1    |
| 7        | 99603      | 7624-5138   | 2           | 4        | HANDLE                                      | 4.3    |
| 8        | 99617      | --          | 4           | 8        | HANDLE LINK PIN                             | 0.9    |
| 9        | 30030-10-0 | 900620-38   | 4           | 8        | COTTER PIN                                  | 0.1    |
| 10       | 99604      | 7624-A-5    | 1           | 2        | SCREW                                       | 4.0    |
| 11       | 99606      | 7624-B-5    | 1           | 2        | NUT   | 1.6    |
| 12       | 99605      | 7624-A-5000 | 1           | 2        | PIVOT BLOCK                                 | 1.4    |
| 13       | 99614      | 7624-D-5    | 2           | 4        | PIVOT BLOCK SCREW                           | 0.3    |
| 14       | 99611      | 7624-A-25   | 1           | 1        | NUT WRENCH                                  | 4.7    |
| --       | 99612      | 7624-A-9    | --          | --       | SAFETY CLAMP BOX                            | 45.0   |
| --       | 99000-SP   | --          | --          | --       | C CLAMP SPARE PARTS KIT                     | --     |

## Safety Clamp Complete with Inserts less Box

| COLLAR SIZE       | BVM P/N | O.E.M. P/N | TOTAL NO. LINKS REQ. PER SIZE | WEIGHT (lbs) |              |
|-------------------|---------|------------|-------------------------------|--------------|--------------|
| 3 3/4" - 4 5/8"   | CS99500 | 7624-5007  | 7                             | 60           |              |
| 4 1/2" - 5 5/8"   | CS99501 | 7624-5008  | 8                             | 66           |              |
| 5 1/2" - 6 5/8"   | CS99502 | 7624-5009  | 9                             | 70           |              |
| 6 1/2" - 7 5/8"   | CS99503 | 7624-5010  | 10                            | 76           |              |
| 7 1/2" - 8 5/8"   | CS99504 | 7624-5011  | 11                            | 81           |              |
| 8 1/2" - 9 5/8"   | CS99505 | 7624-5012  | 12                            | 86           |              |
| 9 1/2" - 10 5/8"  | CS99506 | 7624-5013  | 13                            | 91           |              |
| 10 1/2" - 11 5/8" | CM99507 | 7624-5014  | 14                            | 95           |              |
| 11 1/2" - 12 5/8" | CM99508 | 7624-5015  | 15                            | 103          |              |
| 12 1/2" - 13 5/8" | CM99509 | 7624-5016  | 16                            | 108          |              |
| 13 1/2" - 14 5/8" | CM99510 | 7624-5017  | 17                            | 113          |              |
| 14 1/2" - 15 5/8" | CM99511 | 7624-5018  | 18                            | 118          |              |
| 15 1/2" - 17"     | CL99512 | 7624-5019  | 18                            | 140          | Double Screw |
| 16 1/2" - 18"     | CL99513 | 7624-5020  | 19                            | 146          | Double Screw |
| 17 1/2" - 19"     | CL99514 | 7624-5021  | 20                            | 152          | Double Screw |
| 18 1/2" - 20"     | CL99515 | 7624-5022  | 21                            | 156          | Double Screw |
| 19 1/2" - 21"     | CL99516 | 7624-5023  | 22                            | 161          | Double Screw |
| 21 1/2" - 23"     | CL99517 | 7624-5024  | 24                            | 196          | Double Screw |
| 24 - 27"          | CL99518 | 7624-5025  | 28                            | 225          | Double Screw |
| 29 1/2" - 31"     | CL99519 | 7624-5026  | 34                            | 230          | Double Screw |
| 35 1/2" - 37"     | CL99525 | --         | 38                            | 234          | Double Screw |
| 41 1/2" - 43"     | CL99526 | --         | 44                            | 244          | Double Screw |

NOTE: When ordering, please specify the number of links desired. (Each link equals one inch).

Part Number CS99500 comes with only one handle.