

BVM CASING SLIPS

BVM Casing Slips type "CXL" are designed to handle tubing or casing from 5 1/2" through 30" OD. These slips are light-weight, self-centering and made with a web type construction for support where it's needed. Slips are made from alloy steel, heat treated and tested for maximum durability. All steel specifications are certified.

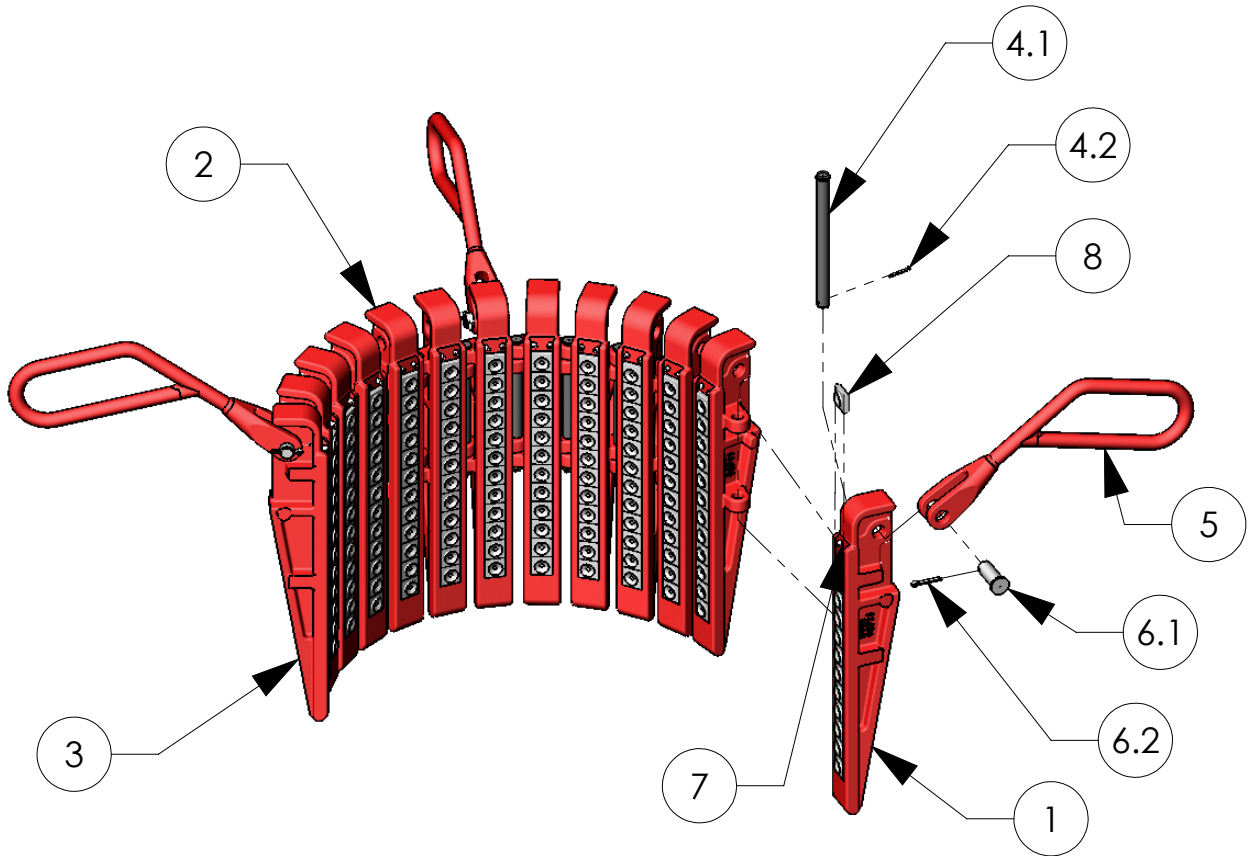

8 5/8" CASING
SLIP SHOWN

GRIP LENGTH (BUTTONS) 13 1/2"

ITEM NO.	PART NO.	DESCRIPTION	WEIGHT (lbs)
1	98710	LEFT HAND SEGMENT	13.4
2	98711	INTERMEDIATE SEGMENT	13.7
3	98712	RIGHT HAND SEGMENT	13.4
4	98715	HINGE PIN w/COTTER PIN	--
4.1	98715-1	HINGE PIN	0.7
4.2	30020-08-0	COTTER PIN	0.1
5	98714	HANDLE	4.3
6	98717	HANDLE PIN w/COTTER PIN	--
6.1	98717-1	HANDLE PIN	0.3
6.2	30030-10-0	COTTER PIN	0.1
7	40040-06-0	ROLL PIN	0.1
8	*	CIRCULAR BUTTON	--

* = See backside of sheet for Circular Button P/N's

BVM CORPORATION
 430 S. NAVAJO STREET, DENVER CO 80223
 PHONE: 303-975-1402; FAX: 303-975-0981
 www.bvmcorp.com; sales@bvmcorp.com

BVM CASING SLIPS

API SIZE (in)	STD INSERT PART NO.	NO SET.	WT. SET	CIRCULAR BUTTON NO.	NO. SET	WT. SET
6 5/8	98719-02	36	36	2628	144	36
7	98719-02	36	36	2619	144	36
7 5/8	98719-03	36	22	2630	144	24
8 5/8	98719-03	39	24	2630	156	36
9 5/8	98719-03	39	24	2630	168	28
10 3/4	98719-03	45	27	2630	180	30
11 3/4	98719-02	51	51	2627	204	51
13 3/8	98719-03	54	32	2630	216	36
16	98719-03	63	38	2631	252	43
18 5/8	98719-02	75	75	2626	300	60
20	98719-03	78	47	2631	312	52
24	98719-03	39	24	2631	360	60
26	98719-03	42	26	2631	396	64
30	98719-03	48	29	2631	444	72

CASING SLIPS COMPLETE WITH INSERT

CASING SIZE (in)	PART NO.	TOTAL NO. OF SEGMENTS	WEIGHT (lbs)	REQUIRED HANDLES
5 1/2	98700	11	174	3
6 5/8	98701	12	200	
7	98702	12	200	
7 5/8	98703	12	200	
8 5/8	98704	13	213	
9 5/8	98705	14	226	4
10 3/4	98706	15	239	
11 3/4	98707	17	265	
13 3/8	98708	18	278	
16	98709	21	317	
18 5/8	98720	25	369	
20	98720	26	382	
24	98722	30	443	
26	98723	33	486	
30	98724	37	536	

NOTE: 5 1/2" Casing Slips Segments not interchangeable with type "CXL" Slips.

CONDUCTOR PIPE SLIP TYPE "CP"

PIPE OD (in)	PART NO.	TOTAL NO. OF SEGMENTS	TOTAL HINGE SPACER	PART NO. FOR HINGE SPACER	WEIGHT COMPLETE (lbs)	INSERT PART NO.
24	99725	13	12	99800	276	03 & 04
28	99726	14	13	99800	296	03 & 04
30	99727	16	15	99800	319	03 & 04

NOTE: Conductor slips furnished with 4 Handles. All parts are interchangeable with type "CXL" Casing Slips EXCEPT Hinge Spacer P/N 99800.